

## Operating Pressure

0-100 psi (690 kPa) without bowl

## Temperature Range

-40° to 250°F (-40° to 121°C)

## Fuel Compatibility

#1 or #2 Diesel, Kerosene, Biodiesel up to B20 and JP8

## Mounting

Engine or Chassis

## Water Removal @ Recommended Flow Rate

SAE J1488 Emulsified: 95% efficiency

SAE J1839 Free Water: 95% efficiency

## Air Bleed Vent

Bleed options available

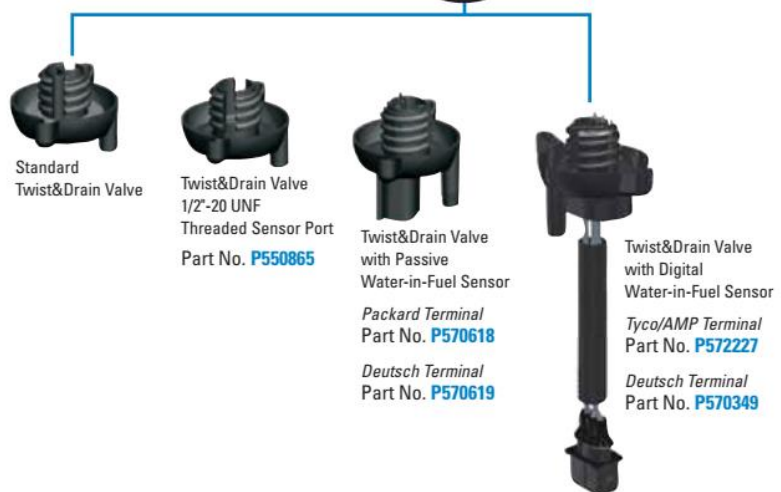
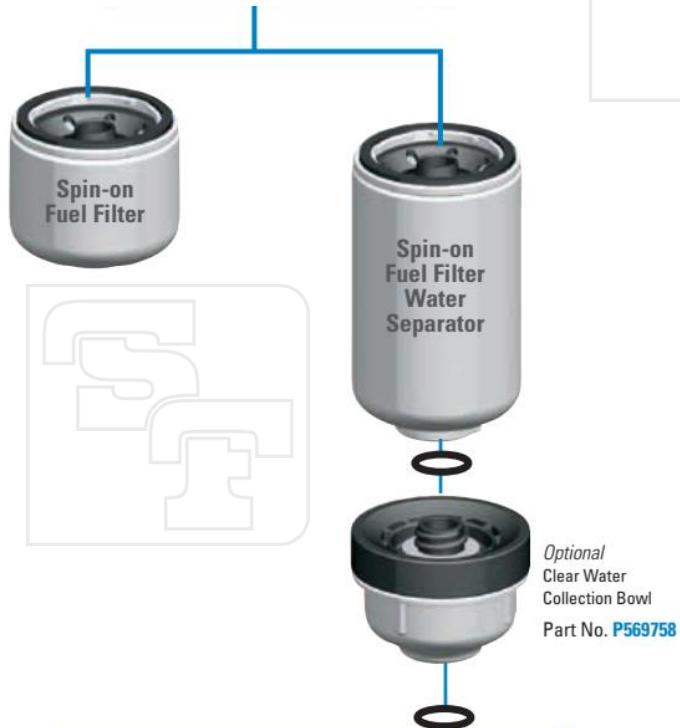

- Donaldson
- Mann Filter
- SF Filter
- Fleetguard
- Hifi Filter
- Separ
- De-Bug
- Wycokmar
- Overdruk
- NTZ



## Operating Pressure

0-100 psi (690 kPa) without bowl

## Temperature Range

-40° to 250°F (-40° to 121°C)

## Fuel Compatibility

#1 or #2 Diesel, Kerosene, Biodiesel up to B20 and JP8

## Mounting

Engine or Chassis

## Water Removal @ Recommended Flow Rate

SAE J1488 Emulsified: 95% efficiency

SAE J1839 Free Water: 95% efficiency

## Air Bleed Vent

Bleed options available

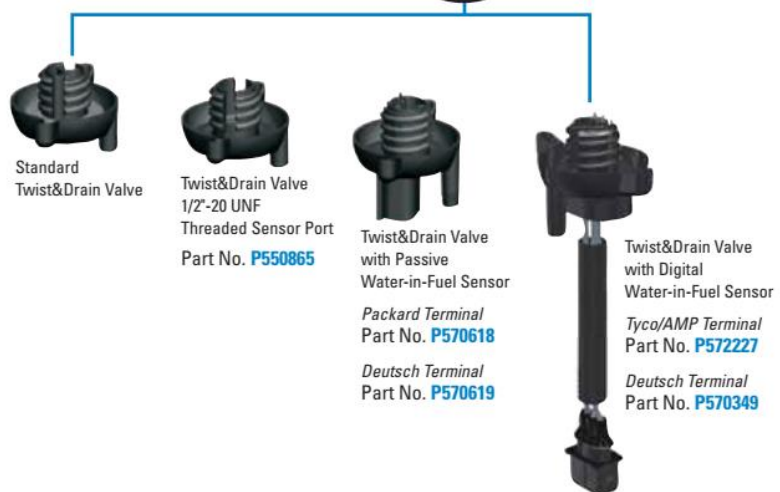
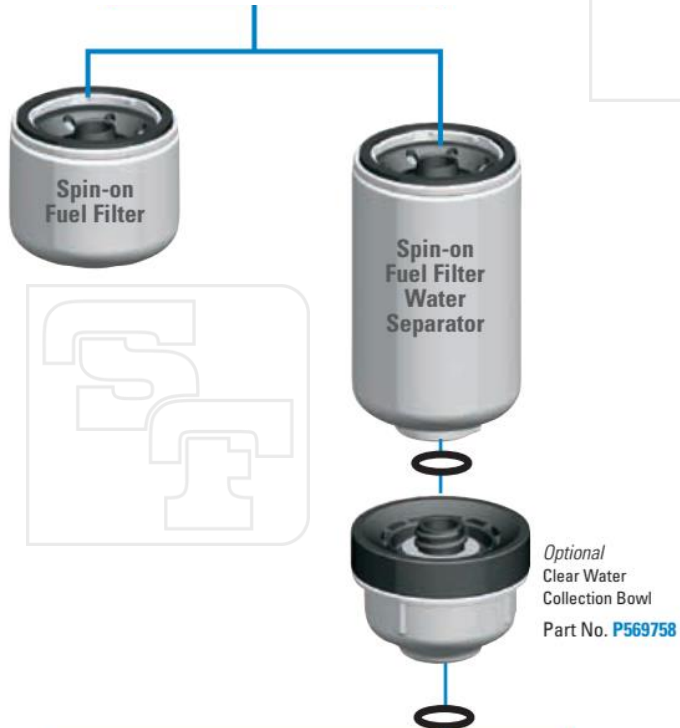
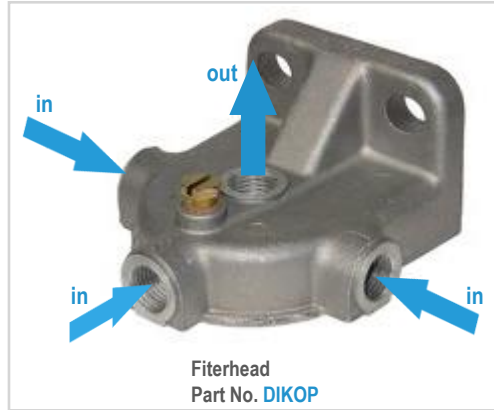

- Donaldson
- Mann Filter
- SF Filter
- Fleetguard
- Hifi Filter
- Separ
- De-Bug
- Wycokmar
- Overdruk
- NTZ

Randweg 1 | 8061 RW Hasselt



Tel: 038 4773800

Fax: 038 4773888

info@snijderfiltertechniek.nl

www.snijderfiltertechniek.nl

## Filter Selection Chart

Filter Style	Max. Recommended Flow Rate		(C) Filter Length*		Media Type	Efficiency @ Micron	Stand Tube	Part Number	Performance Curve	(D) Service Clearance	
	gph	lph	in	mm						in	mm
 Standard Drain	15	57	4.01	102	Treated Cellulose	99% @ 15	No	P551039	B	.93	24
	30	114	5.81	148	Treated Cellulose	99% @ 11	No	P550588	C		
					Synteq	99% @ 3	No	P551615	N/A		
					Treated Cellulose	99% @ 15	Yes	P550248	C		
 No Drain	15	57	3.26	83	Cellulose	99% @ 16	No	P550345	B		
	25	95	4.72	120	Cellulose	99% @ 9	No	P555095	A		
					Cellulose	99% @ 16	Yes	P553004	C		
					Cellulose	99% @ 9	No	P550943	C		
30	114	4.72	120	Cellulose	99% @ 16	Yes	P550440	D			

\* Water Collection Bowl (part no. P569758) adds 1.98" / 50 mm to filter length.

## Performance Curves

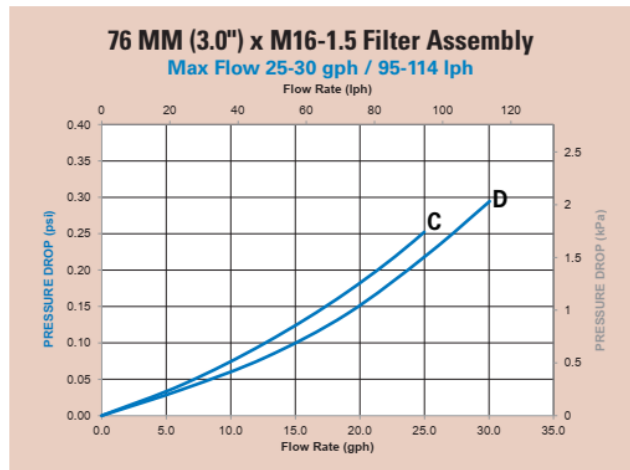
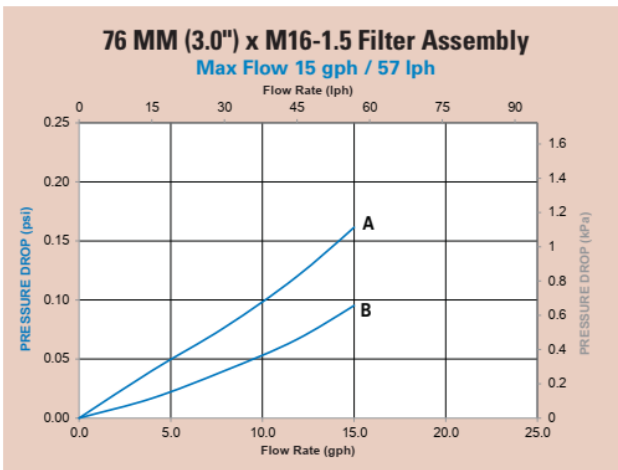

## Optional

Racor S3209P	30 µm	bowl RK30051
Racor S3209T	10 µm	bowl RK30051
Mann WK731	3-5 µm, >20%	no drain
Mann WK842	3-5 µm, >20%	drain
Mann WK842/6	63 µm strainer	drain
Mann WDK725	3-5 µm, 67%	no drain
Mann WDK962/15	3-5 µm, 67%	no drain
Mann WDK962/14	3-5 µm, 95%	no drain
Mann WDK 962/12	3-5 µm, 98,6%	no drain
HiFi SN70389	eq. WDK962/12	no drain

Randweg 1 | 8061 RW Hasselt  
Tel: 038 4773800  
Fax: 038 4773888  
info@snijderfiltertechniek.nl  
www.snijderfiltertechniek.nl